



Euro Profile



Mini industrial coupling with internationally used profile. Frequent use in medical technology and chemistry/pharmacy. Coupling system with single-hand operation. Wide range of applications with different media.

- Available on request:
 - with additional end connections
 - other seals for different temperature ranges and fluids

KA Single Shut-Off

Working Pressure*:
up to 35 bar

Material:

- Coupling: Brass
- Plug: Brass
- Seals: NBR

Working Temperature:
-20°C up to +100°C (NBR)

Flow Rate Air:
165 l/min.
inlet pressure 6 bar, pressure drop 0.5 bar

Flow Rate Air:
1.5 l/min.
pressure drop 0.5 bar

KB Double Shut-Off

Working Pressure*:
up to 35 bar

Material:

- Coupling: Brass
- Plug: Brass
- Seals: NBR

Working Temperature:
-20°C up to +100°C (NBR)

Flow Rate Air:
130 l/min.
inlet pressure 6 bar, pressure drop 0.5 bar

Flow Rate Air:
1.2 l/min.
pressure drop 0.5 bar

* maximum static working pressure with design factor 4 to 1.

Single Shut-Off

Single Shut-Off

20KAA Coupler with valve, Male Thread

Brass, NBR

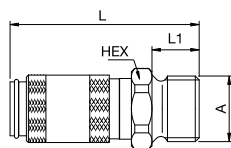

A		HEX	L	L1	D	Version
M5	20KAAM05MPX	9	26	5	10	Brass
M5	20KAAM05MPN	9	26	5	10	Nickel-plated brass
G1/8	20KAAW10MPX	11	28	7	10	Brass
G1/8	20KAAW10MPN	11	28	7	10	Nickel-plated brass

20KAI Coupler with valve, Female Thread

Brass, NBR

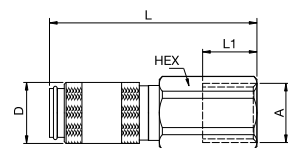

A		HEX	L	L1	D	Version
M5	20KAIM05MPX	9	26	5	10	Brass
M5	20KAIM05MPN	9	26	5	10	Nickel-plated brass
G1/8	20KAIW10MPX	12	28	7	10	Brass
G1/8	20KAIW10MPN	12	28	7	10	Nickel-plated brass

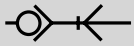

Single Shut-Off

20KATF Coupler with valve, Hose Barb

Brass, NBR

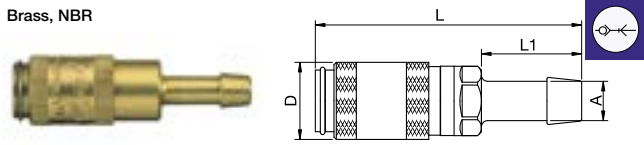

A		L	L1	D	Version
3	20KATF03MPX	35	13	10	Brass
3	20KATF03MPN	35	13	10	Nickel-plated brass
4	20KATF04MPX	35	13	10	Brass
4	20KATF04MPN	35	13	10	Nickel-plated brass
5	20KATF05MPX	35	13	10	Brass
5	20KATF05MPN	35	13	10	Nickel-plated brass

20KAKO Coupler with valve, with Plastic Hose Connection

Brass, NBR

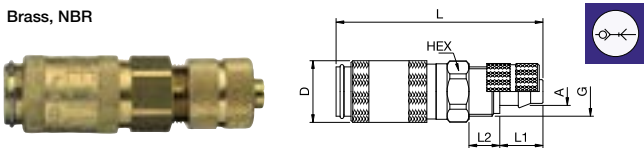

A		HEX	G	L	L1	L2	D	Version
3 x 4	20KAKO04MPX	9	M7x0.5	34	7	5	10	Brass
3 x 4	20KAKO04MPN	9	M7x0.5	34	7	5	10	Nickel-plated brass
3 x 5	20KAKO05MPX	9	M7x0.5	34	7	5	10	Brass
3 x 5	20KAKO05MPN	9	M7x0.5	34	7	5	10	Nickel-plated brass
4 x 6	20KAKO06MPX	9	M8x0.5	34	7	5	10	Brass
4 x 6	20KAKO06MPN	9	M8x0.5	34	7	5	10	Nickel-plated brass

20KAKS Coupler with valve, Panel Mount with Plastic Hose Connection

Brass, NBR

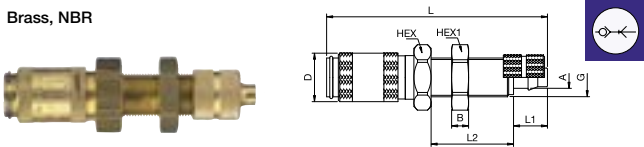

A		HEX	HEX1	B	G	L	L1	L2	D	Version
3 x 4	20KAKS04MPX	12	11	3	M7x0.5	45	7	17	10	Brass
3 x 4	20KAKS04MPN	12	11	3	M7x0.5	45	7	17	10	Nickel-plated brass
3 x 5	20KAKS05MPX	12	11	3	M7x0.5	45	7	17	10	Brass
3 x 5	20KAKS05MPN	12	11	3	M7x0.5	45	7	17	10	Nickel-plated brass
4 x 6	20KAKS06MPX	12	11	3	M8x0.5	45	7	17	10	Brass
4 x 6	20KAKS06MPN	12	11	3	M8x0.5	45	7	17	10	Nickel-plated brass

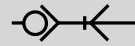

Single Shut-Off

20KATS Coupler with valve, Panel Mount with Hose Barb

Brass, NBR

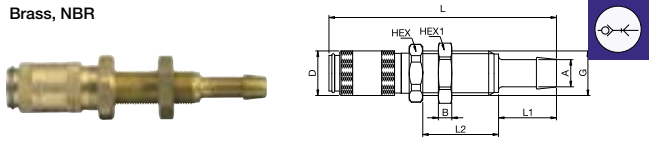

A		HEX	HEX1	B	G	L	L1	L2	D	Version
3	20KATS03MPX	12	11	3	M7x0.5	51	13	17	10	Brass
3	20KATS03MPN	12	11	3	M7x0.5	51	13	17	10	Nickel-plated brass
4	20KATS04MPX	12	11	3	M7x0.5	51	13	17	10	Brass
4	20KATS04MPN	12	11	3	M7x0.5	51	13	17	10	Nickel-plated brass

20KARP Coupler with valve, Push-In

Nickel-plated brass, NBR

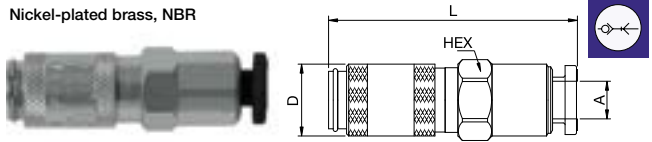

A		HEX	L	D
4	20KARP04MPN	10	35	10

20SFA Plug without valve, Male Thread

Brass

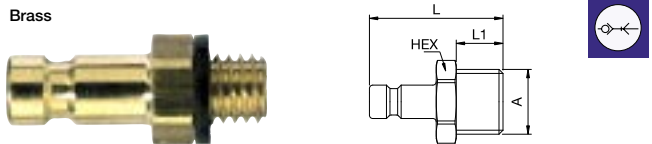

A		HEX	L	L1	Version
M5	20SFAM05MXX	7	18	5	Brass
M5	20SFAM05MXN	9087 20 19	7	18	Nickel-plated brass
G1/8	20SFAW10MXX	11	20	7	Brass
G1/8	20SFAW10MXN	9087 20 10	11	20	Nickel-plated brass

20SFI Plug without valve, Female Thread

Brass

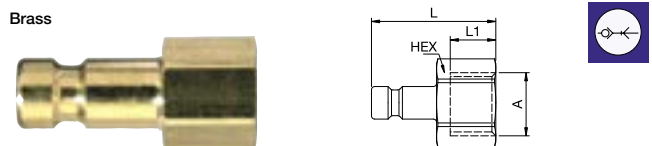

A		HEX	L	L1	Version
M5	20SFIM05MXX	7	17	5	Brass
M5	20SFIM05MXN	9086 20 19	7	17	Nickel-plated brass
G1/8	20SFIW10MXX	12	19	7	Brass
G1/8	20SFIW10MXN	9086 20 10	12	19	Nickel-plated brass

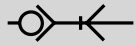

Single Shut-Off

20SFTF Plug without valve, Hose Barb

Brass

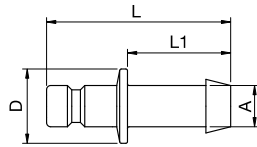

A			L	L1	D	Version
3			24	13	7	Brass
3			24	13	7	Nickel-plated brass
4			24	13	7	Brass
4			24	13	7	Nickel-plated brass
5			22	13	9	Brass
5			22	13	9	Nickel-plated brass

20SFK0 Plug without valve, with Plastic Hose Connection

Brass

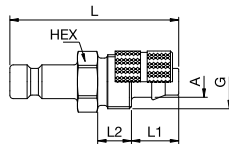

A		HEX	G	L	L1	L2	Version
3 x 4		7	M7x0.5	25	7	5	Brass
3 x 4		7	M7x0.5	25	7	5	Nickel-plated brass
3 x 5		7	M7x0.5	25	7	5	Brass
3 x 5		7	M7x0.5	25	7	5	Nickel-plated brass
4 x 6		8	M8x0.5	25	7	5	Brass
4 x 6		8	M8x0.5	25	7	5	Nickel-plated brass

20SFKS Plug without valve, Panel Mount with Plastic Hose Connection

Brass

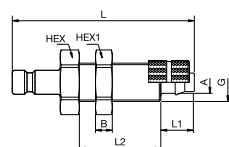

A		HEX	HEX1	B	G	L	L1	L2	Version
3 x 4		11	11	3	M7x0.5	38	7	17	Brass
3 x 4		11	11	3	M7x0.5	38	7	17	Nickel-plated brass
3 x 5		11	11	3	M7x0.5	38	7	17	Brass
3 x 5		11	11	3	M7x0.5	38	7	17	Nickel-plated brass
4 x 6		12	12	3	M8x0.5	38	7	17	Brass
4 x 6		12	12	3	M8x0.5	38	7	17	Nickel-plated brass

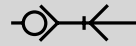

Single Shut-Off

20SFTS Plug without valve, Panel Mount with Hose Barb

Brass

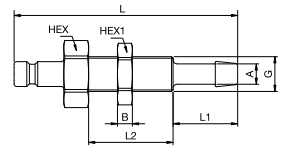

A			HEX	HEX1	B	G	L	L1	L2	Version
3			12	11	3.5	M7x0.5	45	13	18	Brass
3			12	11	3.5	M7x0.5	45	13	18	Nickel-plated brass
4			12	11	3	M7x0.5	45	13	17	Brass
4			12	11	3	M7x0.5	45	13	17	Nickel-plated brass

20SFRP Plug without valve, Push-In

Nickel-plated brass, NBR

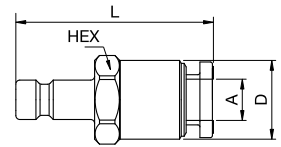

A		HEX	L	D
4		10	35	10



Double Shut-off

20KBA Coupler with valve, Male Thread

Brass, NBR

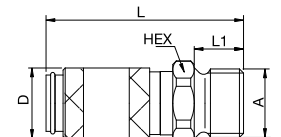

A			HEX	L	L1	D	Version
M5			9	26	5	10	Brass
M5			9	26	5	10	Nickel-plated brass
G1/8			11	28	7	10	Brass
G1/8			11	28	7	10	Nickel-plated brass

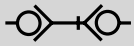

Double Shut-off

20KBI Coupler with valve, Female Thread

Brass, NBR

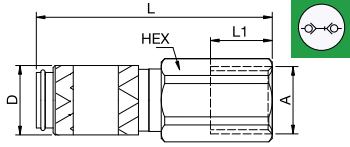

A	Version	HEX	L	L1	D	Version
M5	20KBIM05MPX	9	26	5	10	Brass
M5	20KBIM05MPN	9	26	5	10	Nickel-plated brass
G1/8	20KBIW10MPX	12	28	7	10	Brass
G1/8	20KBIW10MPN	12	28	7	10	Nickel-plated brass

20KBT Coupler with valve, Hose Barb

Brass, NBR

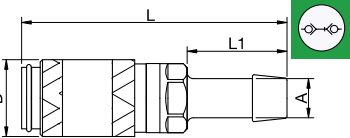

A	Version	L	L1	D	Version
3	20KBTf03MPX	35	13	10	Brass
3	20KBTf03MPN	35	13	10	Nickel-plated brass
4	20KBTf04MPX	35	13	10	Brass
4	20KBTf04MPN	35	13	10	Nickel-plated brass
5	20KBTf05MPX	35	13	10	Brass
5	20KBTf05MPN	35	13	10	Nickel-plated brass

20KBKO Coupler with valve, with Plastic Hose Connection

Brass, NBR

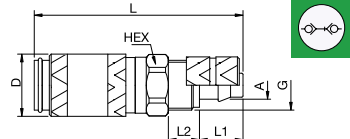

A	Version	HEX	G	L	L1	L2	D	Version
3 x 4	20KBK004MPX	9	M7x0.5	34	7	5	10	Brass
3 x 4	20KBK004MPN	9	M7x0.5	34	7	5	10	Nickel-plated brass
3 x 5	20KBK005MPX	9	M7x0.5	34	7	5	10	Brass
3 x 5	20KBK005MPN	9	M7x0.5	34	7	5	10	Nickel-plated brass
4 x 6	20KBK006MPX	9	M8x0.5	34	7	5	10	Brass
4 x 6	20KBK006MPN	9	M8x0.5	34	7	5	10	Nickel-plated brass

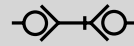

Double Shut-off

20KBKS Coupler with valve, Panel Mount with Plastic Hose Connection

Brass, NBR

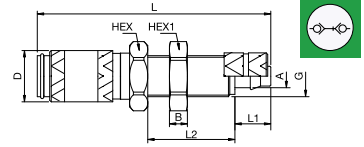

A	Version	HEX	HEX1	B	G	L	L1	L2	D	Version
3 x 4	20KBKS04MPX	12	11	3	M7x0.5	45	7	17	10	Brass
3 x 4	20KBKS04MPN	12	11	3	M7x0.5	45	7	17	10	Nickel-plated brass
3 x 5	20KBKS05MPX	12	11	3	M7x0.5	45	7	17	10	Brass
3 x 5	20KBKS05MPN	12	11	3	M7x0.5	45	7	17	10	Nickel-plated brass
4 x 6	20KBKS06MPX	12	12	3.5	M8x0.5	45	7	17	10	Brass
4 x 6	20KBKS06MPN	12	12	3.5	M8x0.5	45	7	17	10	Nickel-plated brass

20KBTS Coupler with valve, Panel Mount with Hose Barb

Brass, NBR

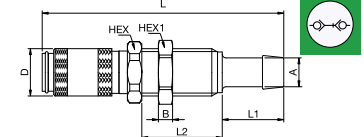

A	Version	HEX	HEX1	B	G	L	L1	L2	D	Version
3	20KBTS03MPX	12	11	3	M7x0.5	51	13	17	10	Brass
3	20KBTS03MPN	12	11	3	M7x0.5	51	13	17	10	Nickel-plated brass
4	20KBTS04MPX	12	11	3	M7x0.5	51	13	17	10	Brass
4	20KBTS04MPN	12	11	3	M7x0.5	51	13	17	10	Nickel-plated brass

20KBRP Coupler with valve, Push-In

Nickel-plated brass, NBR

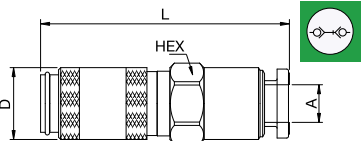

A	Version	HEX	L	D
4	20KBRP04MPN	10	35	10

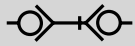

Double Shut-off

20SBA Plug with valve, Male Thread

Brass, NBR

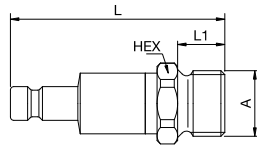

A			HEX	L	L1	Version
M5			9	28	5	Brass
M5			9	28	5	Nickel-plated brass
G1/8			11	30	7	Brass
G1/8			11	30	7	Nickel-plated brass

20SBI Plug with valve, Female Thread

Brass, NBR

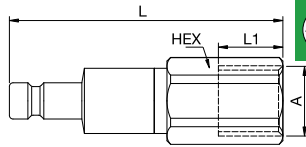

A			HEX	L	L1	Version
M5			9	26	5	Brass
M5			9	26	5	Nickel-plated brass
G1/8			12	30	7	Brass
G1/8			12	30	7	Nickel-plated brass

20SBTF Plug with valve, Hose Barb

Brass, NBR

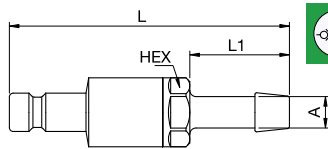

A			HEX	L	L1	Version
3			8	36	13	Brass
3			8	36	13	Nickel-plated brass
4			8	36	13	Brass
4			8	36	13	Nickel-plated brass
5			8	36	13	Brass
5			8	36	13	Nickel-plated brass

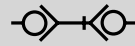

Double Shut-off

20SBKO Plug with valve, with Plastic Hose Connection

Brass, NBR

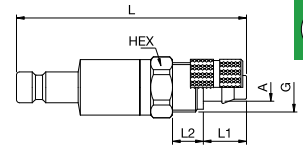

A			HEX	G	L	L1	L2	Version
3 x 4			9	M7x0.5	30.5	7	5	Brass
3 x 4			9	M7x0.5	30.5	7	5	Nickel-plated brass
3 x 5			9	M7x0.5	30.5	7	5	Brass
3 x 5			9	M7x0.5	30.5	7	5	Nickel-plated brass
4 x 6			9	M8x0.5	30.5	7	5	Brass
4 x 6			9	M8x0.5	30.5	7	5	Nickel-plated brass

20SBKS Plug with valve, Panel Mount with Plastic Hose Connection

Brass, NBR

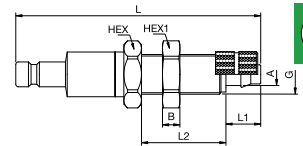

A			HEX	HEX1	B	G	L	L1	L2	D	Version
3 x 4			12	11	3	M7x0.5	46.5	7	17	10	Brass
3 x 4			12	11	3	M7x0.5	46.5	7	17	10	Nickel-plated brass
3 x 5			12	11	3	M7x0.5	46.5	7	17	10	Brass
3 x 5			12	11	3	M7x0.5	46.5	7	17	10	Nickel-plated brass
4 x 6			12	12	3.5	M8x0.5	46.5	7	17	10	Brass
4 x 6			12	12	3.5	M8x0.5	46.5	7	17	10	Nickel-plated brass

20SBTS Plug with valve, Panel Mount with Hose Barb

Brass, NBR

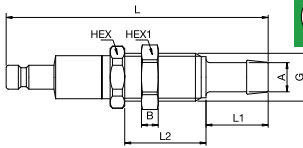
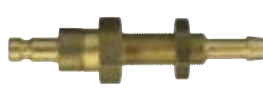

A			HEX	HEX1	B	G	L	L1	L2	Version
3			12	11	3	M7x0.5	52.5	13	17	Brass
3			12	11	3	M7x0.5	52.5	13	17	Nickel-plated brass
4			12	11	3	M7x0.5	52.5	13	17	Brass
4			12	11	3	M7x0.5	52.5	13	17	Nickel-plated brass

20SBRP Plug with valve, Push-In

Nickel-plated brass, NBR

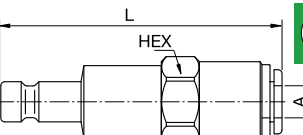

A			HEX	L
3 x 4			10	34