

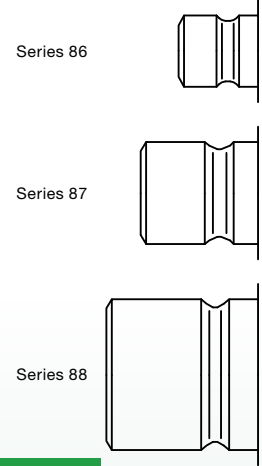

The 86, 87 and 88 Rectus Moldtite coupling series were especially developed for connecting coolant lines and injection moulds. Countersunk plugs can easily be connected and disconnected because of the extended sleeve. The angular connections prevent kinks from forming in the hose.

- Available in:
  - single shut-off, double shut-off or straight-through versions
- The shut-off couplings (with valve) are equipped with nickel plated sleeves for quick and accurate visual differentiation



**KF** Straight-Through

**Working Pressure\*:**  
up to 15 bar

**Material:**

- Coupling: Brass
- Plug: Brass
- Seals: FKM

**Working Temperature:**  
-15°C up to +200°C (FKM)

**Flow Rate Water:**

- Series 86: 17 l/min.
- Series 87: 29 l/min.
- Series 88: 94 l/min.

pressure drop 0.5 bar

**KA** Single Shut-Off

**Working Pressure\*:**  
up to 15 bar

**Material:**

- Coupling: Brass
- Plug: Brass
- Seals: FKM

**Working Temperature:**  
-15°C up to +200°C (FKM)

**Flow Rate Water:**

- Series 86: 9 l/min.
- Series 87: 16 l/min.
- Series 88: 55 l/min.

pressure drop 0.5 bar

**KB** Double Shut-Off

**Working Pressure\*:**  
up to 15 bar

**Material:**

- Coupling: Brass
- Plug: Brass
- Seals: FKM

**Working Temperature:**  
-15°C up to +200°C (FKM)

**Flow Rate Water:**

- Series 86: 8 l/min.
- Series 87: 15 l/min.

pressure drop 0.5 bar

\* maximum static working pressure with design factor 4 to 1.

→|← Straight-Through

## 86/87/88KFAW Coupler without valve, Male Thread

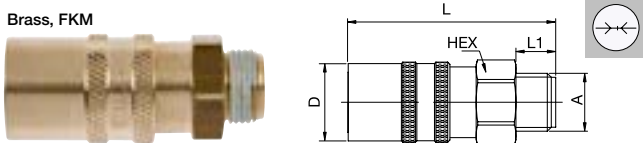

DN	Series	A	HEX	L	L1	D
6	86	G1/4	86KFAW13MVX	17	47	9 18
		G3/8	86KFAW17MVX	19	47	9 18
9	87	G1/4	87KFAW13MVX	22	56.5	9 24
		G3/8	87KFAW17MVX	22	56.5	9 24
		G1/2	87KFAW21MVX	22	59.5	12 24
13	88	G1/2	88KFAW21MVX	30	73	12 32

→|← Straight-Through

## 86/87/88KFIW Coupler without valve, Female Thread

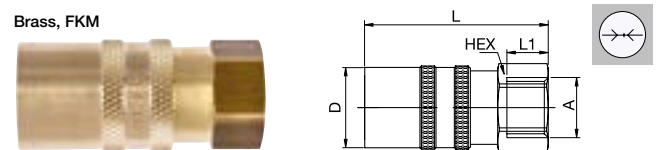

DN	Series	A	HEX	L	L1	D
6	86	G1/8	86KFIW10MVX	17	40	12 18
		G1/4	86KFIW13MVX	17	40	12 18
9	87	G1/4	87KFIW13MVX	21	51.5	10 24
		G3/8	87KFIW17MVX	21	51.5	10 24
13	88	G1/2	88KFIW21MVX	30	68	12 32



Straight-Through

## 86/87/88KFTF Coupler without valve, Hose Barb

Brass, FKM

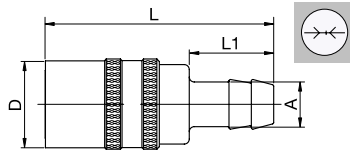

DN	Series	A		L	L1	D
6	86	6	<a href="#">86KFTF06MVX</a>	46	17	18
		9	<a href="#">86KFTF09MVX</a>	46	22	18
9	87	9	<a href="#">87KFTF09MVX</a>	64	22	24
		13	<a href="#">87KFTF13MVX</a>	66.5	25	24
13	88	19	<a href="#">88KFTF19MVX</a>	89	32	32

## 86/87/88KFTR Coupler without valve, Hose Barb 90°

Brass, FKM

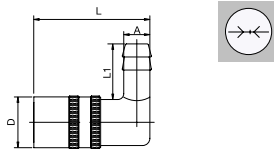

DN	Series	A		L	L1	D
6	86	6	<a href="#">86KFTR06MVX</a>	40	17	18
		9	<a href="#">86KFTR09MVX</a>	40	22	18
9	87	9	<a href="#">87KFTR09MVX</a>	56	22	24
		13	<a href="#">87KFTR13MVX</a>	56	28.5	24
13	88	19	<a href="#">88KFTR19MVX</a>	77	32	32

## 86/87KFTH Coupler without valve, Hose Barb 45°

Brass, FKM

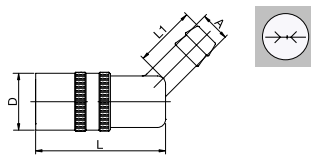

DN	Series	A		L	L1	D
6	86	6	<a href="#">86KFTH06MVX</a>	40	17	18
		9	<a href="#">86KFTH09MVX</a>	40	22	18
9	87	9	<a href="#">87KFTH09MVX</a>	56	22	24
		13	<a href="#">87KFTH13MVX</a>	56	25	24



Straight-Through

## 86/87KFTP Coupler without valve, Push-Lok

Brass, FKM

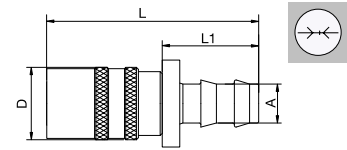

DN	Series	A		L	L1	D
6	86	6	<a href="#">86KFTP06MVX</a>	49	20.4	18
		10	<a href="#">86KFTP10MVX</a>	53	24.2	18
9	87	10	<a href="#">87KFTP10MVX</a>	65.5	24.2	24
		13	<a href="#">87KFTP13MVX</a>	69.5	27.9	24

## 86/87KFPR Coupler without valve, Push-Lok 90°

Brass, FKM

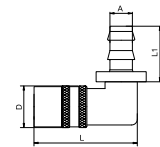

DN	Series	A		L	L1	D
6	86	6	<a href="#">86KFPR06MVX</a>	45	20.4	18
		10	<a href="#">86KFPR10MVX</a>	45	24.2	18
9	87	10	<a href="#">87KFPR10MVX</a>	61.5	24.2	24
		13	<a href="#">87KFPR13MVX</a>	61.5	27.9	24

## 86/87KFPH Coupler without valve, Push-Lok 45°

Brass, FKM

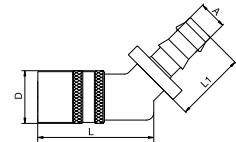

DN	Series	A		L	L1	D
6	86	6	<a href="#">86KFPH06MVX</a>	40	20.4	18
		10	<a href="#">86KFPH10MVX</a>	40	24.2	18
9	87	10	<a href="#">87KFPH10MVX</a>	56	24.2	24
		13	<a href="#">87KFPH13MVX</a>	56	27.9	24



Single Shut-off / Double shut-off

## 86/87/88KBAW Coupler with valve, Male Thread

Brass, FKM

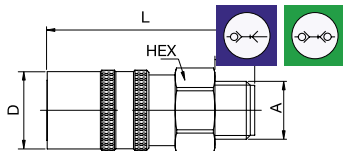

DN	Series	A		HEX	L	L1	D
6	86	G1/4	86KBAW13MVX	17	47	9	18
		G3/8	86KBAW17MVX	19	47	9	18
9	87	G1/4	87KBAW13MVX	22	56.5	9	24
		G3/8	87KBAW17MVX	22	56.5	9	24
		G1/2	87KBAW21MVX	22	59.5	12	24
13	88	G1/2	88KAAW21MVX	30	73	12	32

## 86/87/88KBIW Coupler with valve, Female Thread

Brass, FKM

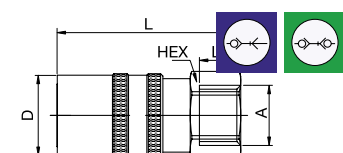

DN	Series	A		HEX	L	L1	D
6	86	G1/8	86KBIW10MVX	17	40	12	18
		G1/4	86KBIW13MVX	17	40	12	18
9	87	G1/4	87KBIW13MVX	21	51.5	10	24
		G3/8	87KBIW17MVX	21	51.5	10	24
13	88	G1/2	88KAIW21MVX	30	68	12	32

## 86/87/88KBTf Coupler with valve, Hose Barb

Brass, FKM

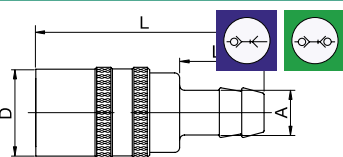

DN	Series	A		L	L1	D
6	86	6	86KBTf06MVX	46	17	18
		9	86KBTf09MVX	46	22	18
9	87	9	87KBTf09MVX	64	22	24
		13	87KBTf13MVX	66.5	25	24
13	88	19	88KATf19MVX	89	32	32



Single Shut-off / Double shut-off

## 86/87/88KBTR Coupler with valve, Hose Barb 90°

Brass, FKM

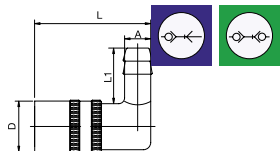

DN	Series	A		L	L1	D
6	86	6	86KBTR06MVX	40	17	18
		9	86KBTR09MVX	40	22	18
9	87	9	87KBTR09MVX	56	22	24
		13	87KBTR13MVX	56	28.5	24
13	88	19	88KATR19MVX	77	32	32

## 86/87KBTH Coupler with valve, Hose Barb 45°

Brass, FKM

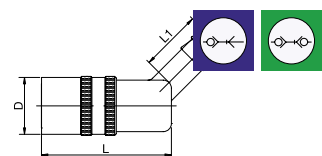

DN	Series	A		L	L1	D
6	86	6	86KBTH06MVX	40	17	18
		9	86KBTH09MVX	40	22	18
9	87	9	87KBTH09MVX	56	22	24
		13	87KBTH13MVX	56	25	24

## 86/87KBTP Coupler with valve, Push-Lok

Brass, FKM

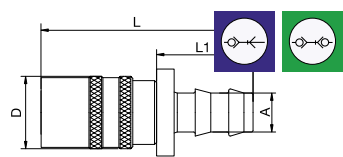

DN	Series	A		L	L1	D
6	86	6	86KBTP06MVX	49	20.4	18
		10	86KBTP10MVX	53	24.2	18
9	87	10	87KBTP10MVX	65.5	24.2	24
		13	87KBTP13MVX	69.5	27.9	24

 Single Shut-off / Double shutt-off

## 86/87KBPR Coupler with valve, Push-Lok 90°

Brass, FKM

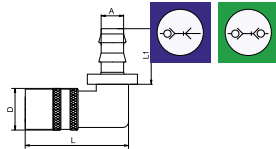

DN	Series	A		L	L1	D
6	86	6	<a href="#">86KBPR06MVX</a>	45	20.4	18
		10	<a href="#">86KBPR10MVX</a>	45	24.2	18
9	87	10	<a href="#">87KBPR10MVX</a>	61.5	24.2	24
		13	<a href="#">87KBPR13MVX</a>	61.5	27.9	24

## 86/87KBPH Coupler with valve, Push-Lok 45°

Brass, FKM

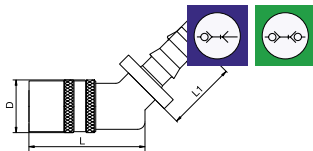

DN	Series	A		L	L1	D
6	86	6	<a href="#">86KBPH06MVX</a>	40	20.4	18
		10	<a href="#">86KBPH10MVX</a>	40	24.2	18
9	87	10	<a href="#">87KBPH10MVX</a>	56	24.2	24
		13	<a href="#">87KBPH13MVX</a>	56	27.9	24

 Straight-Through / Single Shut-off

## 86/87/88SFA Plug without valve, Male Thread

Brass

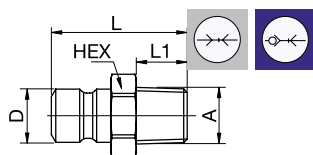

DN	Series	A		HEX	L	L1	D
6	86	M10 x 1	<a href="#">86SFAM10MXX</a>	13	23	8	9.5
		R1/8	<a href="#">86SFAK10MXX</a>	13	24	9	9.5
		R1/4	<a href="#">86SFAK13MXX</a>	16	29	12	9.5
		R3/8	<a href="#">86SFAK17MXX</a>	19	30	12	9.5
9	87	R1/4	<a href="#">87SFAK13MXX</a>	16	34	12	13.5
		R3/8	<a href="#">87SFAK17MXX</a>	19	34	12	13.5
13	88	R1/2	<a href="#">87SFAK21MXX</a>	24	39	17	13.5
		R1/2	<a href="#">88SFAK21MXX</a>	22	44	17	20
		R3/4	<a href="#">88SFAK26MXX</a>	29	45	19	20

 Straight-Through / Single Shut-off

## 86/87SFAR Plug without valve, Male Thread 90° tapered

Brass

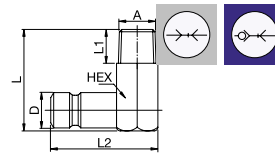

DN	Series	A		HEX	L	L1	L2	D
6	86	R1/8	<a href="#">86SFAR10MXX</a>	11	27	9	28.5	9.5
		R1/4	<a href="#">86SFAR13MXX</a>	14	27	9	32	9.5
9	87	R1/4	<a href="#">87SFAR13MXX</a>	15	34	9	32	13.5
		R3/8	<a href="#">87SFAR17MXX</a>	19	37	12	36	13.5

## 86/87SFIW Plug without valve, Female Thread

Brass

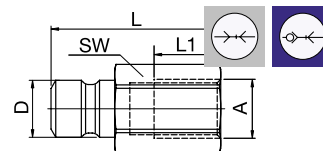

DN	Series	A		HEX	L	L1	D
6	86	G1/8	<a href="#">86SFIW10MXX</a>	13	28	11	9.5
		G1/4	<a href="#">86SFIW13MXX</a>	16	32	13	9.5
9	87	G1/4	<a href="#">87SFIW13MXX</a>	16	37	13	13.5
		G3/8	<a href="#">87SFIW17MXX</a>	19	39	16	13.5

## 86/87SFTF Plug without valve, Hose Barb

Brass

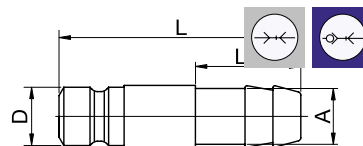

DN	Series	A		L	L1	D
6	86	9	<a href="#">86SFTF09MXX</a>	39	22	9.5
9	87	13	<a href="#">87SFTF13MXX</a>	41	21	13.5

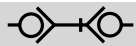

Double Shut-off

## 86/87SBAK Plug with valve, Male Thread

Brass, FKM

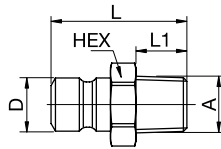
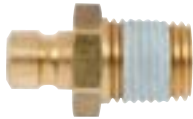

DN	Series	A		HEX	L	L1	D
6	86	R1/4	<a href="#">86SBAK13MVX</a>	6	29	14	9.5
9	87	R1/4	<a href="#">87SBAK13MVX</a>	16	34	12	13.5
		R3/8	<a href="#">87SBAK17MVX</a>	19	34	12	13.5



Straight-Through

## 86/87VN Extension Plug, Male Thread

Brass



DN	Series	A		HEX	L	L1	D
6	86	R1/8	<a href="#">86VN1010MXX</a>	11	100	9	9.5
		R1/8	<a href="#">86VN1015MXXS_01</a>	11	150	9	9.5
		R1/8	<a href="#">86VN1025MXX</a>	11	250	9	9.5
9	87	R1/4	<a href="#">87VN1315MXX</a>	15	150	12	13.5
		R1/4	<a href="#">87VN1325MXX</a>	15	250	12	13.5
6	86	G1/8	<a href="#">86VN1010MXXS_01</a>	11	100	60	9.5
		G1/4	<a href="#">86VN1310MXX</a>	14	100	60	9.5
9	87	G1/4	<a href="#">87VN1310MXX</a>	14	100	60	13.5
		G3/8	<a href="#">87VN1710MXX</a>	17	100	60	13.5