

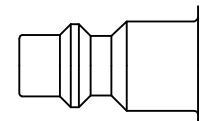

Safety coupling with a self-venting system for ISO 6150 B plug profile. Self-venting takes place during disconnection – no risk of pressurised hoses being tossed around. When the Push-Button is pressed for the first time, air is relieved from the coupling but the plug in the coupling remains locked. The plug is only disconnected when the Push-Button is pressed for the second time. System fulfils the requirements of ISO4414 – increased safety standards in the work place. DIN EN 983. Coupling body is 360° rotating so Push-Button is visible in any position.



ISO 6150 B Profile



**KE** Self-Venting System

**Working Pressure\*:**

up to 12 bar

**Material:**

- Coupling: Anodised Aluminium, Nickel plated brass
- Plug: Nickel plated steel
- Seals: NBR

**Working Temperature:**

-20°C up to +100°C (NBR)

**Flow Rate Air:**

675 l/min.

inlet pressure 6 bar, pressure drop 0.5 bar

\* maximum static working pressure with design factor 4 to 1.



## Self-Venting System

### 24KPAW Coupler with valve, Male Thread

Anodised aluminium, nickel-plated brass

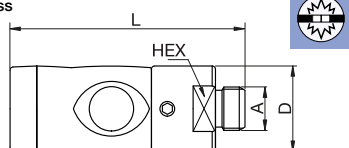

A



HEX L D

G1/4	24KPAW13APX	22	71.6	26
G3/8	24KPAW17APX	22	71.6	26
G1/2	24KPAW21APX	22	74.6	26



## Self-Venting System

### 24KPTF Coupler with valve, Hose Barb

Anodised aluminium, nickel-plated brass

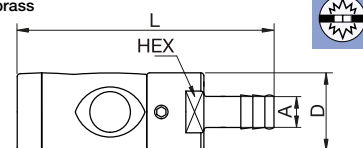

A



HEX L D

6	24KPTF06APX	22	85.4	26
8	24KPTF08APX	22	85.4	26
10	24KPTF10APX	22	85.4	26

### 24KPIW Coupler with valve, Female Thread

Anodised aluminium, nickel-plated brass

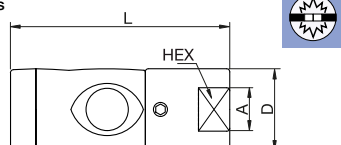

A



HEX L D

G1/4	24KPIW13APX	22	70.1	26
G3/8	24KPIW17APX	22	72.1	26
G1/2	24KPIW21APX	22	74.1	26



## Self-Venting System

### 23SFAK Plug without valve, Male Thread

Nickel-plated steel

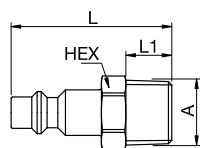

HEX L L1

R1/4	23SFAK13SXN	14	42	12
R3/8	23SFAK17SXN	17	42	12
R1/2	23SFAK21SXN	22	48	17

### 23SFIW Plug without valve, Female Thread

Nickel-plated steel

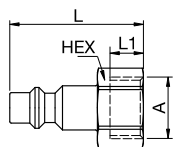

HEX L L1

G1/4	23SFIW13SXN	9086 23 13	17	36	9
G3/8	23SFIW17SXN	9086 23 17	19	36	9
G1/2	23SFIW21SXN	9086 23 21	24	39	12

### 23SFTF Plug without valve, Hose Barb

Nickel-plated steel

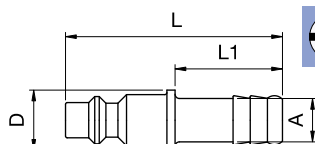

L L1 D

6	23SFTF06SXN	9085 23 06	51	25	14
8	23SFTF08SXN	9085 23 08	51	25	14
10	23SFTF10SXN	9085 23 10	51	25	14