



1/4" Safety coupling with a self-venting system according to ISO 6150 B. Self-venting takes place during disconnection – no risk of pressurised hoses being tossed around. When the sleeve is pulled back, the plug is released yet remains locked in. The coupling valve closes and the air is vented from the air line at the same time. Only then, by operating the sleeve again, can uncoupling take place safely. The system fulfils the requirements of ISO 4414 – increased safety standards in the work place. The plastic sleeve does not scratch working surfaces.

- Available on request:
 - with additional end connections

Safety Note

Reliable functioning can only be guaranteed in conjunction with original Parker Rectus plugs made of steel.

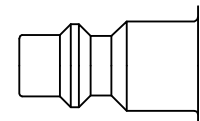

ISO B Profile



KE Self-Venting System

Working Pressure*:
up to 12 bar

Material:

- Coupling: Nickel plated brass
- Plug: Nickel plated steel
- Seals: NBR

Working Temperature:

-20°C up to +60°C (NBR)

Flow Rate Air:

830 l/min.

inlet pressure 6 bar, pressure drop 0.5 bar

* maximum static working pressure with design factor 4 to 1.



Self-Venting System

24KEAK Coupler with valve, Male Thread

Nickel-plated brass, NBR

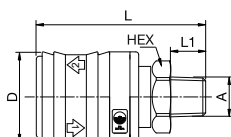

A		HEX	L	L1	D
R1/4	24KEAK13MPN	22	58	9	31
R3/8	24KEAK17MPN	22	58	9	31
R1/2	24KEAK21MPN	24	63	12	31



Self-Venting System

24KETF Coupler with valve, Hose Barb

Nickel-plated brass, NBR

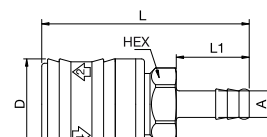

A		HEX	L	L1	D
6	24KETF06MPN	22	71	25	31
8	24KETF08MPN	22	71	25	31
9	24KETF09MPN	22	71	25	31
10	24KETF10MPN	22	71	25	31
13	24KETF13MPN	22	71	25	31

24KEIW Coupler with valve, Female Thread

Nickel-plated brass, NBR

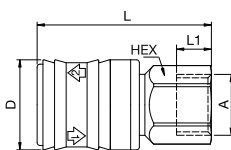

A		HEX	L	L1	D
G1/4	24KEIW13MPN	22	57	9	31
G3/8	24KEIW17MPN	22	57	9	31
G1/2	24KEIW21MPN	24	60	12	31



Self-Venting System

23SFAK Plug without valve, Male Thread

Nickel-plated steel

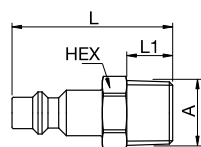

A		HEX	L	L1
R1/8	23SFAK10SXN	13	39	9
R1/4	23SFAK13SXN	14	42	12
R3/8	23SFAK17SXN	17	42	12
R1/2	23SFAK21SXN	22	48	17

23SFIW Plug without valve, Female Thread

Nickel-plated steel

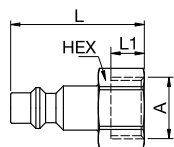

A			HEX	L	L1
G1/8	23SFIW10SXN	9086 23 10	14	36	9
G1/4	23SFIW13SXN	9086 23 13	17	36	9
G3/8	23SFIW17SXN	9086 23 17	19	36	9
G1/2	23SFIW21SXN	9086 23 21	24	39	12

23SFTF Plug without valve, Hose Barb

Nickel-plated steel

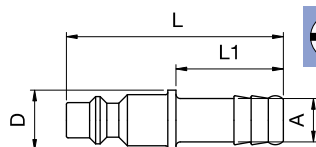

A			L	L1	D
6	23SFTF06SXN	9085 23 06	51	25	14
8	23SFTF08SXN	9085 23 08	51	25	14
9	23SFTF09SXN		51	25	14
10	23SFTF10SXN	9085 23 10	51	25	14
13	23SFTF13SXN		51	25	14