

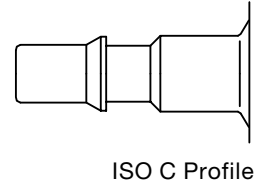

Robust industrial coupling according to ISO 6150 C. Coupling system with single-hand operation. High Flow valve for optimum flow and low pressure drop.  
The steel sleeve counters oscillating forces. System has limited use for liquids (steel sleeve/zinc die cast valve). The high insertion depth guarantees by an optimised plug guidance.

- Available on request:
  - with additional end connections
  - other seals for different temperature ranges and fluids



Dust Protections (P. 357)  
for Coupling Part.-No. SK23S

KA
Single Shut-Off

**Working Pressure\*:**  
up to 35 bar

**Material:**

- Coupling: Nickel plated brass / steel
- Plug: Nickel plated steel
- Seals: NBR

**Working Temperature:**  
-20°C up to +100°C (NBR)

**Flow Rate Air:**  
970 l/min.  
inlet pressure 6 bar, pressure drop 0.5 bar

**Flow Rate Water:**  
12.7 l/min.  
pressure drop 0.5 bar

\* maximum static working pressure with design factor 4 to 1.

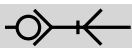

Single Shut-Off

## 18KAAK Coupler with valve, Male Thread

Nickel-plated brass/steel, NBR

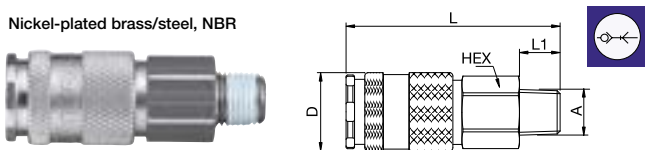

A		HEX	L	L1	D
R1/4	18KAAK13MPN	19	63	12	23
R3/8	18KAAK17MPN	19	62	12	23
R1/2	18KAAK21MPN	22	63	17	23

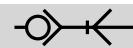

Single Shut-Off

## 18KATF Coupler with valve, Hose Barb

Nickel-plated brass/steel, NBR

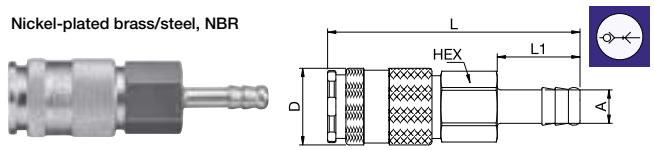

A			HEX	L	L1	D
6	18KATF06MPN	9123 18 06	19	76	25	23
8	18KATF08MPN	9123 18 08	19	76	25	23
10	18KATF10MPN	9123 18 10	19	76	25	23
13	18KATF13MPN		19	76	25	23

## 18KAIW Coupler with valve, Female Thread

Nickel-plated brass/steel, NBR

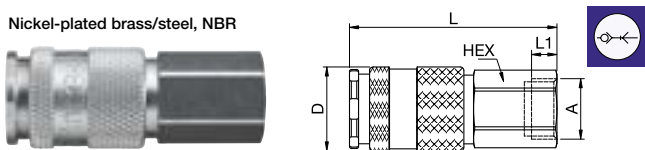

A			HEX	L	L1	D
G1/4	18KAIW13MPN	9114 18 13	19	58	9	23
G3/8	18KAIW17MPN	9114 18 17	19	57	9	23
G1/2	18KAIW21MPN		24	60	12	23

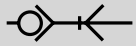

Single Shut-Off

## 18SFAW Plug without valve, Male Thread

Nickel-plated steel

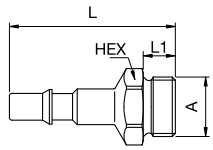

A			HEX	L	L1
G1/4	<b>18SFAW13SXN</b>	<b>9087 18 13</b>	17	41	9
G3/8	<b>18SFAW17SXN</b>	<b>9087 18 17</b>	19	41	9

## 18SFIW Plug without valve, Female Thread

Nickel-plated steel

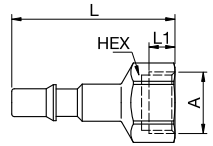

A			HEX	L	L1
G1/4	<b>18SFIW13SXN</b>	<b>9086 18 13</b>	17	43	9
G3/8	<b>18SFIW17SXN</b>	<b>9086 18 17</b>	19	44	9

## 18SFTF Plug without valve, Hose Barb

Nickel-plated steel

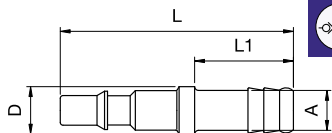

A			L	L1	D
6	<b>18SFTF06SXN</b>	<b>9085 18 06</b>	59	25	12
8	<b>18SFTF08SXN</b>	<b>9085 18 08</b>	59	25	12
10	<b>18SFTF10SXN</b>	<b>9085 18 10</b>	59	25	12