

Characteristics according to VDI 3293 Pressures quoted as gauge pressure

Characteristics	Symbol	Unit	Description	
General Features				
Type			Poppet valve	
Mounting			2 through-bolts M5	
Tube connection			Thread	
Port size			G1/8	
Weight (mass)		kg	0.05	
Installation			In any position	
Ambient temperature range	ϑ_{\min} ϑ_{\max}	°C °C	-20 +80	Note: When using below freezing point (°C) it is necessary to consult us
Medium temperature range	ϑ_{\min} ϑ_{\max}	°C °C	0 +80	
Medium			Filtered compressed air	
Lubrication			With or without oil mist lubrication	
Pneumatic Characteristics				
Nominal pressure	p_n	bar	6	
Operating pressure range	p_{\min} p_{\max}	bar bar	0.5 10	
Nominal flow	Q_N	l/min	134	

AND-Valve

G1/8

(dual pressure valve)

Actuation: Pneumatic

Series AND

AND8-1/8

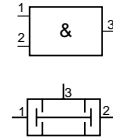

Dimensions (mm)

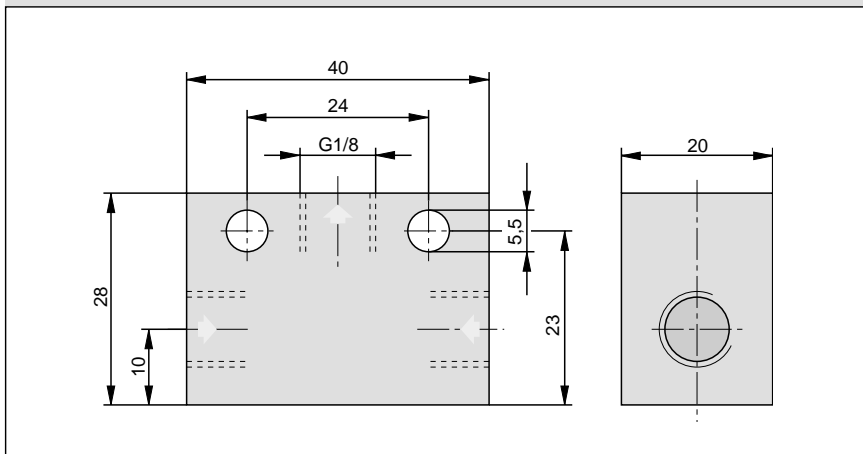

A1P207E00JX00X

The right to introduce technical modifications is reserved

Order Instruction: AND8-1/8 PA 10207

For product group list see 4.01.001E

Data Sheet No. 4.90.002E

