

## Check valves G1/8, G1/4

*In-line version*

*Series RV*

RV series check valves are designed for continuous flow (not suitable for pulsating flow).



Characteristics			Pressures quoted as gauge pressure	
Characteristics	Symbol	Unit	Description	
General features				
Type			Spring loaded check valve	
Mounting			Directly in tubing	
Tube connection			Thread	
Port size			G1/8	G1/4
Weight (mass)		kg	0.02	0.02
Installation				
In any position				
Ambient temperature range	$T_{min}$ $T_{max}$	°C	-20 +80	Note: When using below freezing point (0 °C) it is necessary to consult us
Medium temperature range	$T_{min}$ $T_{max}$	°C	0 +80	
Medium			Filtered compressed air, gases, fluids	
Lubrication			Oil mist lubrication compatible with Buna N	
Pneumatic characteristics				
Nominal pressure	$p_n$	bar	6	
Operating pressure range	$p_{min}$	bar	0.5	
	$p_{max}$	bar	10	
Nominal flow	$Q_N$	l/min	700	1000
Flow direction			In one direction	
Differential pressure for opening the check valve		bar	< 0.5	

### Dimensions

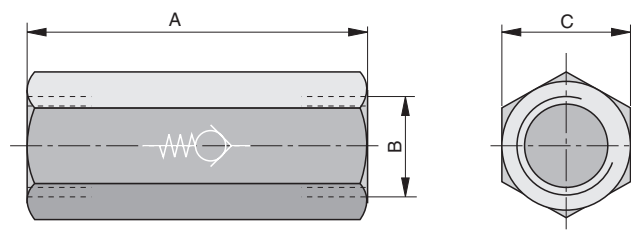

### Dimension table and order instructions

Order Instructions		Dimension		
Type	Order No.	A	B	C
RV-06	PA10024	40	G1/8	SW17
RV-08	PA12007	45	G1/4	SW17

Dimensions in mm

