

P3Y Lubricator - Large

- Integral 3/4" or 1" ports (BSPP and NPT)
- Robust but lightweight aluminium construction
- Proportional oil delivery over a wide range of air flows
- Possible to fill under system pressure eliminating down time
- Large oil reservoir

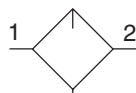

Lubricator with drain

Port Size	Description	Part Number
3/4"	Oil Mist, Fill Under Pressure	P3YLA16LSNN
1"	Oil Mist, Fill Under Pressure	P3YLA18LSNN

Operating Information

Supply pressure (max)*:	254 psig (17.5 bar)
Operating temperature*:	14°F to 140°F (-10°C to 60°C)
Flow capacity†:	3/4" 315 scfm (148.2 dm ³ /s, ANR) 1" 390 scfm (184.1 dm ³ /s, ANR)
Fluid:	Compressed air
Weight:	1.8 lb (0.8 kg)

† Inlet pressure 91.4 psig (6.3 bar) inlet pressure and 7.3 psig (0.5 bar) pressure drop.

* Air supply must be dry enough to avoid ice formation at temperatures below 35.6°F (2°C).

Low flow start point (lubrication pick-up): at 6.3 bar (91.4 psig) inlet pressure 0.5 dm³/s (1.1 scfm).

Ordering Information:

P3YLA
|
1
|
6
|
LSNN

<table border="1" style="width: 100%; border-collapse: collapse;"> <tr> <th style="background-color: #333; color: white;">Basic Series</th> <td></td> </tr> <tr> <td style="background-color: #333; color: white;">Lubricator</td> <td style="background-color: #f9c796;">P3YLA</td> </tr> </table>	Basic Series		Lubricator	P3YLA	<table border="1" style="width: 100%; border-collapse: collapse;"> <tr> <th style="background-color: #333; color: white;">Thread Type*</th> <td></td> </tr> <tr> <td style="background-color: #333; color: white;">BSPP</td> <td style="background-color: #f9c796;">1</td> </tr> <tr> <td style="background-color: #333; color: white;">NPT</td> <td style="background-color: #f9c796;">9</td> </tr> </table>	Thread Type*		BSPP	1	NPT	9	<table border="1" style="width: 100%; border-collapse: collapse;"> <tr> <th style="background-color: #333; color: white;">Port Size</th> <td></td> </tr> <tr> <td style="background-color: #333; color: white;">3/4"</td> <td style="background-color: #f9c796;">6</td> </tr> <tr> <td style="background-color: #333; color: white;">1"</td> <td style="background-color: #f9c796;">8</td> </tr> </table>	Port Size		3/4"	6	1"	8
Basic Series																		
Lubricator	P3YLA																	
Thread Type*																		
BSPP	1																	
NPT	9																	
Port Size																		
3/4"	6																	
1"	8																	

* Note: For 1-1/2" ported unit, please order P3YKA*BCP port block kit separately.

Most Popular



Material Specifications

Body	Aluminium
Sight glass and bowl	Polypropylene
Sight dome	Polyamide
Lubricator cover	ABS
Top & bottom end cap	Glass filled nylon
Bayonet support	Nylon
Seals	Nitrile NBR

Repair and Service Kits

Bowl kit	P3YKA00BSN
Refill plug	P3YKA00PL
Lubricator Oil VG32 - 1 litre 0,92 kg	P3YKA00PPBB

Flow Characteristics

(3/4") Lubricator

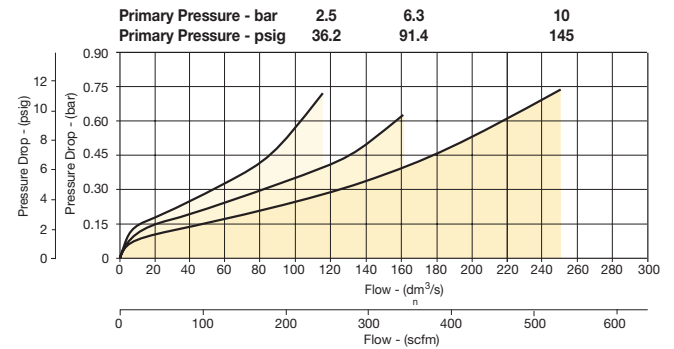

(1") Lubricator

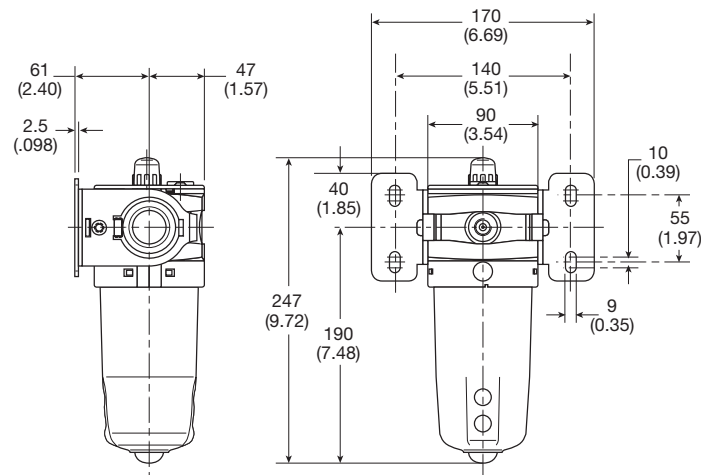
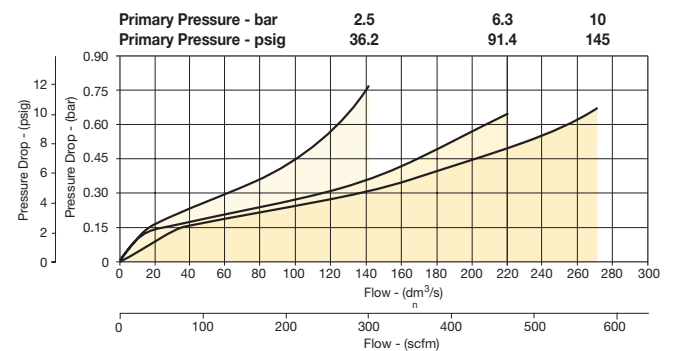

mm (Inches)

Most Popular

