

Metal Quick-Acting Couplers

In order to fulfill the requirements of the **widest range of industrial applications**, Parker Legris offers a range of metal couplers compatible with a large selection of fluids.

Simple to install, with or without shut-off valves, these couplers offer a **high flow rate capability**.

Product Advantages

Easy-to-Use

- Coupler with sliding sleeve: automatic connection and disconnection
- Extremely compact
- Single or double shut-off models for greater safety
- Special range designed for pneumatic applications: mini and standard series
- Special range designed for the transmission of water and fluids: midi and maxi series

Robust & Reliable

- 100% leak-tested in production
- Excellent shock and impact resistance
- Nickel-plated brass for corrosion resistance

Optimum Performance

- Very wide range of flow rates
- Low pressure drop
- Long service life
- Maximum energy efficiency



Applications

- Workshops
- Flushing
- Spraying
- Packaging
- Factory Automation
- Filling Systems
- Cleaning

Technical Characteristics

Compatible Fluids	Compressed air, water
Working Pressure	0 to 20 bar
Working Temperature	-20°C to +100°C

Guaranteed for use with a vacuum of 655 mm Hg (86% vacuum).

Component Materials

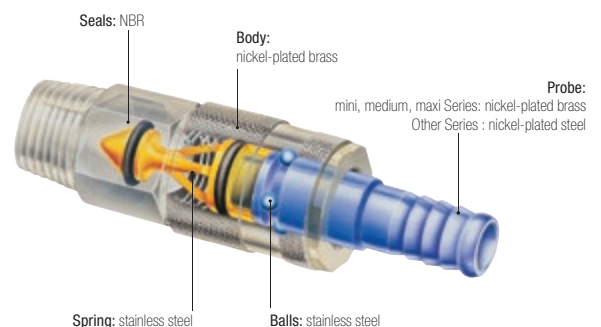

Silicone-free

Metal Quick-Acting Couplers

Metal Quick-Acting Coupler Technology and Flow Rates

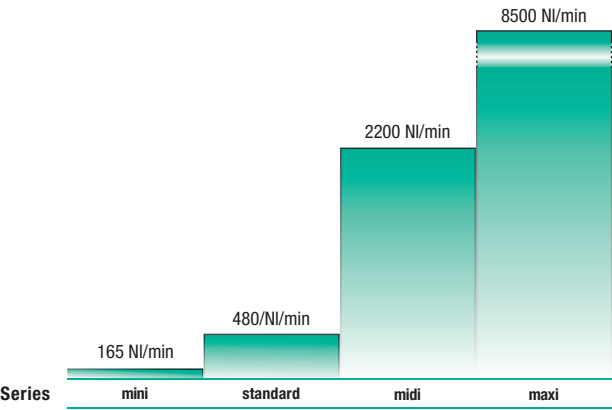

Measurements carried out in accordance with ISO 6358 at a pressure of 6 bar, pressure drop < 0.7 bar (single shut-off flow)

3 Shut-Off Functions

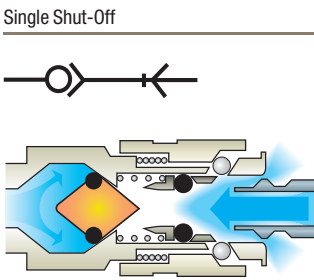
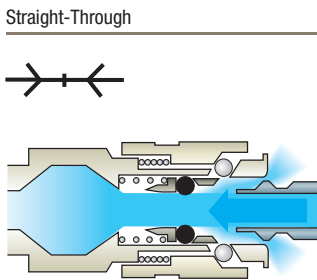

Single shut-off coupler
+ probe without shut-off
When disconnected, the fluid path is closed upstream (body side).

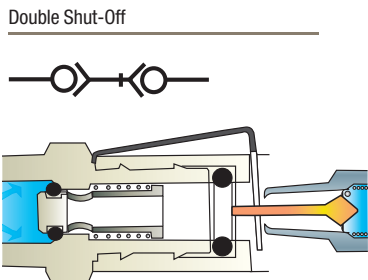

Double shut-off coupler
+ probe with shut-off
When disconnected, the fluid path is closed upstream (body side) and downstream (probe side).

Operation



Mini Series

Single Shut-Off

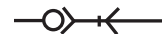

Double Shut-Off

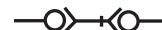

0171 Coupler, Male BSPT and Parallel Metric Thread

Technical polymer, nickel-plated brass, NBR

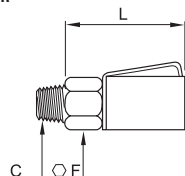

DN	C		E	F	L	Kg
2	M7x1	0171 02 55 01	6	10	21	0.007
		0171 02 10 01	7.5	10	21	0.010
	R1/8	0171 02 10 02	7.5	10	21	0.010
		0171 02 10 03	7.5	10	21	0.010
		0171 02 10 04	7.5	10	21	0.010
		0171 02 10 05	7.5	10	21	0.010

Single shut-off

Mini Series (DN 2): single shut-off= 165 NI/min

0183 Probe, Valved, Male BSPT Thread

Nickel-plated brass, NBR

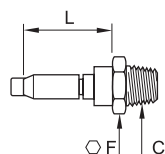

DN	C		F	L	Kg
2	R1/8	0183 02 10	10	13	0.007

Probe with shut-off

0184 Probe, Straight-Through, Male BSPT Thread

Nickel-plated brass

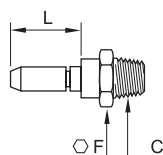

DN	C		F	L	Kg
2	R1/8	0184 02 10	10	13	0.006

Probe without shut-off

0181 Probe without shut-off, Male BSPT Thread

Nickel-plated brass

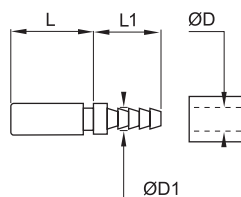

DN	ØD	ØD1		L	L1	Kg
2	3	3.3	0181 03 04	11.5	13.5	0.010

Probe without shut-off

Mini Series

Single Shut-Off



Double Shut-Off

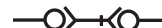

0171 Coupler, Straight-Through, Male BSPT Thread

Technical polymer, nickel-plated brass, NBR

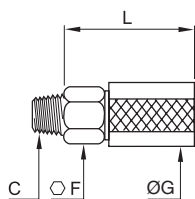

DN	C		F	G	L	Kg
3	R1/8	0171 03 10 01	13	17	24.5	0.020
		0171 03 10 02	13	17	24.5	0.020
		0171 03 10 03	13	17	24.5	0.020
		0171 03 10 04	13	17	24.5	0.020
		0171 03 10 05	13	17	24.5	0.020

Straight-through

0181 Probe, Straight-Through with Barb Connection for Polyamide (PA) Tubing

Nickel-plated brass

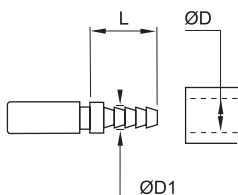

DN	ØD	ØD1		L	Kg
3	4	4.7	0181 04 06	19	0.005

Probe without shut-off

0180 Probe, Straight-Through with Barb Connection for Flexible Tubing

Nickel-plated brass

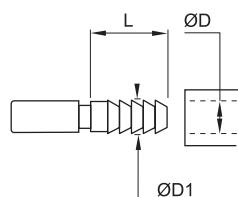

DN	ØD	ØD1		L	Kg
3	4	6	0180 04 00	19	0.007
	5	6.5	0180 05 00	19	0.007

Probe without shut-off

3150 Probe, Straight-Through with LF 3000® Push-In Connection

Nickel-plated brass, NBR

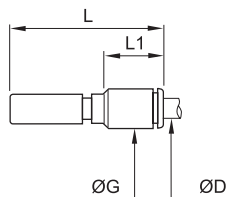

DN	ØD		G	L	L1	Kg
3	4	3150 00 61	8.5	39	18	0.008

Probe without shut-off

Standard Series



0172 Coupler, Female BSPP Thread

Nickel-plated brass, NBR

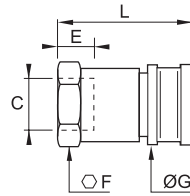

DN	C		E	F	G	L	Kg
5	G1/4	0172 05 13	11	19	21	47	0.086

Standard Series: single shut-off = 480 NI/min

0187 Probe, Straight-Through, Male BSPP Thread

Zinc-plated blister steel

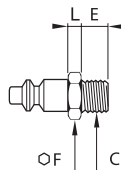

DN	C		E	F	L	Kg
5	G1/8	0187 05 10	7	14	4	0.018
	G1/4	0187 05 13	9.5	17	5	0.027

Probe without shut-off

0186 Probe, Straight-Through, Female BSPP Thread

Zinc-plated blister steel

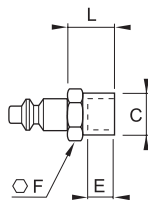

DN	C		E	F	L	Kg
5	G1/4	0186 05 13	12	17	17	0.027

Probe without shut-off

0185 Probe, Straight-Through, with Barb Connection for Flexible Tubing

Zinc-plated blister steel

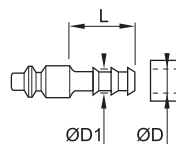

DN	ØD	ØD1		L	Kg
	4	6	0185 04 00	22.5	0.014
5	7	9	0185 07 00	22.5	0.017
	10	12.2	0185 10 00	22.5	0.013

Probe without shut-off

0189 Double Probe

Zinc-plated blister steel

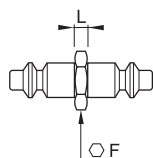

DN		F	L	Kg
5	0189 05 00	12	4	0.025

Probe without shut-off