

lockable ball valves

0499 double female lockable vented ball valve – NPT thread

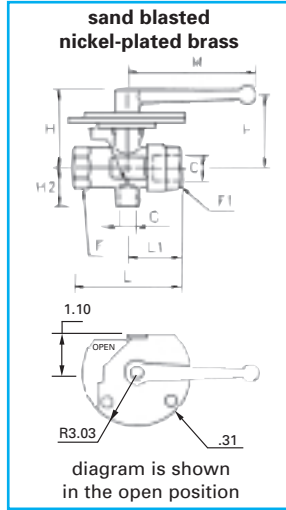

C	NPT orifice	C1	F	F1	H	H1	H2	L	L1	M	T	kg	
1/4	.27	0499 07 14	10-32	.94	.94	1.79	1.68	.66	2.30	1.21	2.69	.08	9.83
3/8	.39	0499 10 18	10-32	.94	.94	1.79	1.68	.66	2.30	1.21	2.69	.08	11.71
1/2	.51	0499 13 22	1/8	1.05	1.05	1.83	1.72	.94	2.61	1.33	2.69	.08	11.39
3/4	.70	0499 18 28	1/4	1.25	1.25	2.46	2.11	1.29	3.12	1.52	4.21	.10	26.95
1"	.90	0499 23 35	1/4	1.60	1.60	2.61	2.22	1.44	3.67	1.83	4.21	.12	38.74

These ball valves are OSHA approved.

0439 double female with vent – BSPP thread

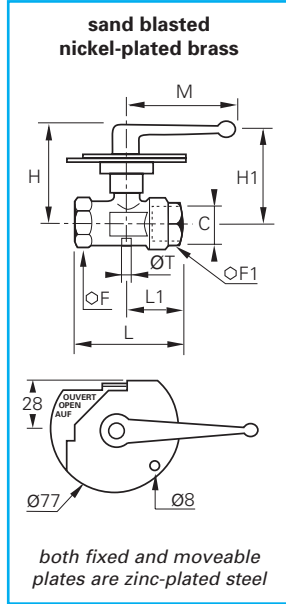

C	BSPP	E	F	F1	H	H1	L	L1	M	T	kg	
G1/8	4	0439 04 10	8	19	19	59	54	51	27	69	2	.42
G1/4	7	0439 07 13	12	24	24	60	55	59	31	69	2	.48
G3/8	10	0439 10 17	12	24	24	60	55	59	31	69	2	.46
G1/2	13	0439 13 21	15	27	27	62	57	67	34	69	2	.51
G3/4	18	0439 18 27	16.5	32	38	66	56	80	39	108	2.5	.83
G1"	23	0439 23 34	19	41	46	70	59	94	47	108	3	1.17

maximum service pressure: 580 psi
handle is non-removable

0437 in-line double female vented lockable ball valve – BSPP thread

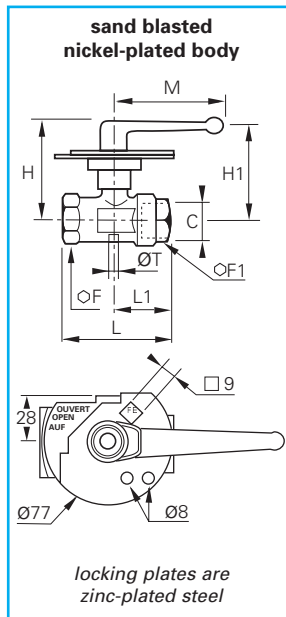

C	BSPP	E	F	F1	H	L	L1	M	T	kg	
G1/4	7	0437 07 13	12	24	24	60	59	32	69.5	2	.40
G3/8	10	0437 10 17	12	24	24	60	60	32	69.5	2	.46
G1/2	13	0437 13 21	15	27	27	60	67.5	34.5	69.5	2	.52
G3/4	18	0437 18 27	16.5	32	38	69.5	80	39.5	108.5	2.5	.85
G1"	23	0437 23 34	19	41	46	73	94.5	47.5	108.5	3	1.17

maximum working pressure: 580 psi
handle is non-removable