

# Snap Fittings



The snap fittings enable a circuit to be isolated without the need to vent the complete system.

Ø metric:  
6 to 10 mm

## Technical Characteristics

- **Compatible Fluids:** Compressed air
- **Working Pressure:** 0 to 10 bar
- **Working Temperature:** -20°C to +80°C
- **Flow Characteristics at 6 bar:** DN 5 mm: 1000 NI/min  
DN 7 mm: 1900 NI/min

Tightening Torque (BSPT)	Thread	G1/8	G1/4	G3/8
	daN.m		0.8	1.2

## Advantages

- Partial venting of systems for energy and time-saving during maintenance operations
- Protection of individuals by maintaining pressure if necessary
- Audible click indicates connection
- Circuit identification by coloured rings (on request)

## Component Materials

Silicone-free

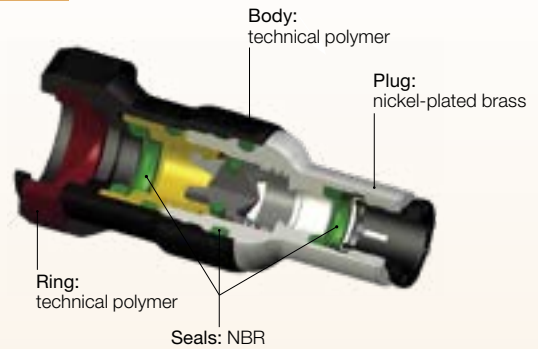

## Regulations

- RoHS
- REACH
- PED

## Operation

### Circuit Closed

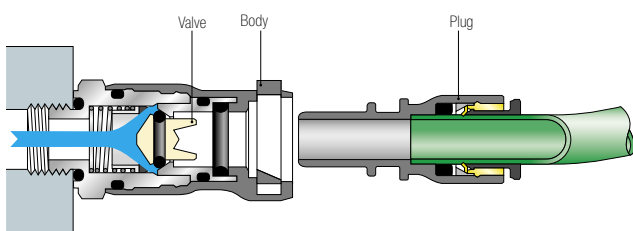

### Circuit Open

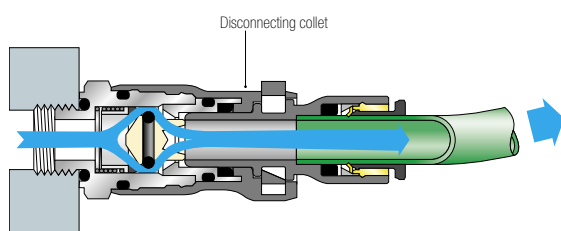

## Flow Characteristics - Pressure Drop

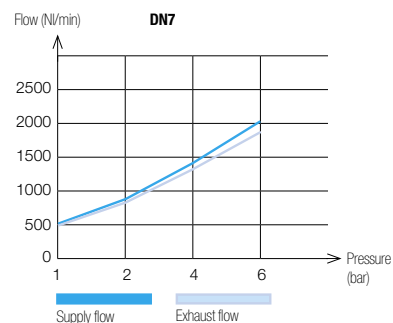
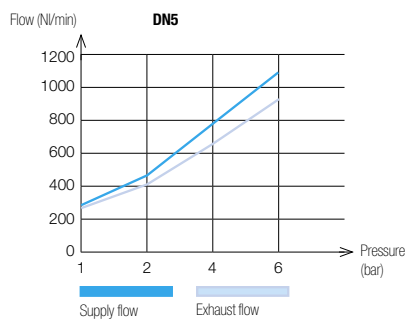

## 7926 Body with Push-In Connection

Technical polymer, Nickel-plated brass, NBR

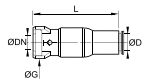

DN	ØD		G	L	Kg
5	6	<b>7926 05 06</b>	18.5	44	0.020
5	8	<b>7926 05 08</b>	18.5	49	0.024
7.3	10	<b>7926 07 10</b>	22	58.5	0.044

## 7960 Straight Probe, Push-In Connection

Technical polymer, NBR

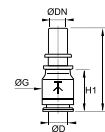

DN	ØD		G	H	H1	Kg
5	6	<b>7960 05 06</b>	13.5	36.5	17.5	0.007
5	8	<b>7960 05 08</b>	13.5	37	18	0.003
7.3	10	<b>7960 07 10</b>	16	41	20.5	0.004

## 7921 Body with Male BSPP Thread

Technical polymer, Nickel-plated brass, NBR

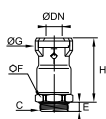

DN	C		E	F	G	H	Kg
5	G1/8	<b>7921 05 10</b>	5.5	16	18.5	31.5	0.021
5	G1/4	<b>7921 05 13</b>	5.5	16	18.5	31.5	0.023
7.3	G1/4	<b>7921 07 13</b>	5.5	20	22	37.5	0.039
7.3	G3/8	<b>7921 07 17</b>	5.5	20	22	37.5	0.040

## 7961 Straight Probe, Male BSPP Thread

Technical polymer, Nickel-plated brass, NBR

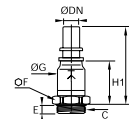

DN	C		E	F	G	H	H1	Kg
5	G1/8	<b>7961 05 10</b>	5.5	13	13.5	46	27	0.017
5	G1/4	<b>7961 05 13</b>	5.5	16	13.5	46	27	0.020
7.3	G1/4	<b>7961 07 13</b>	5.5	16	16	51.5	31	0.025
7.3	G3/8	<b>7961 07 17</b>	5.5	20	16	51.5	31	0.034